

Van Buskirk Community Center

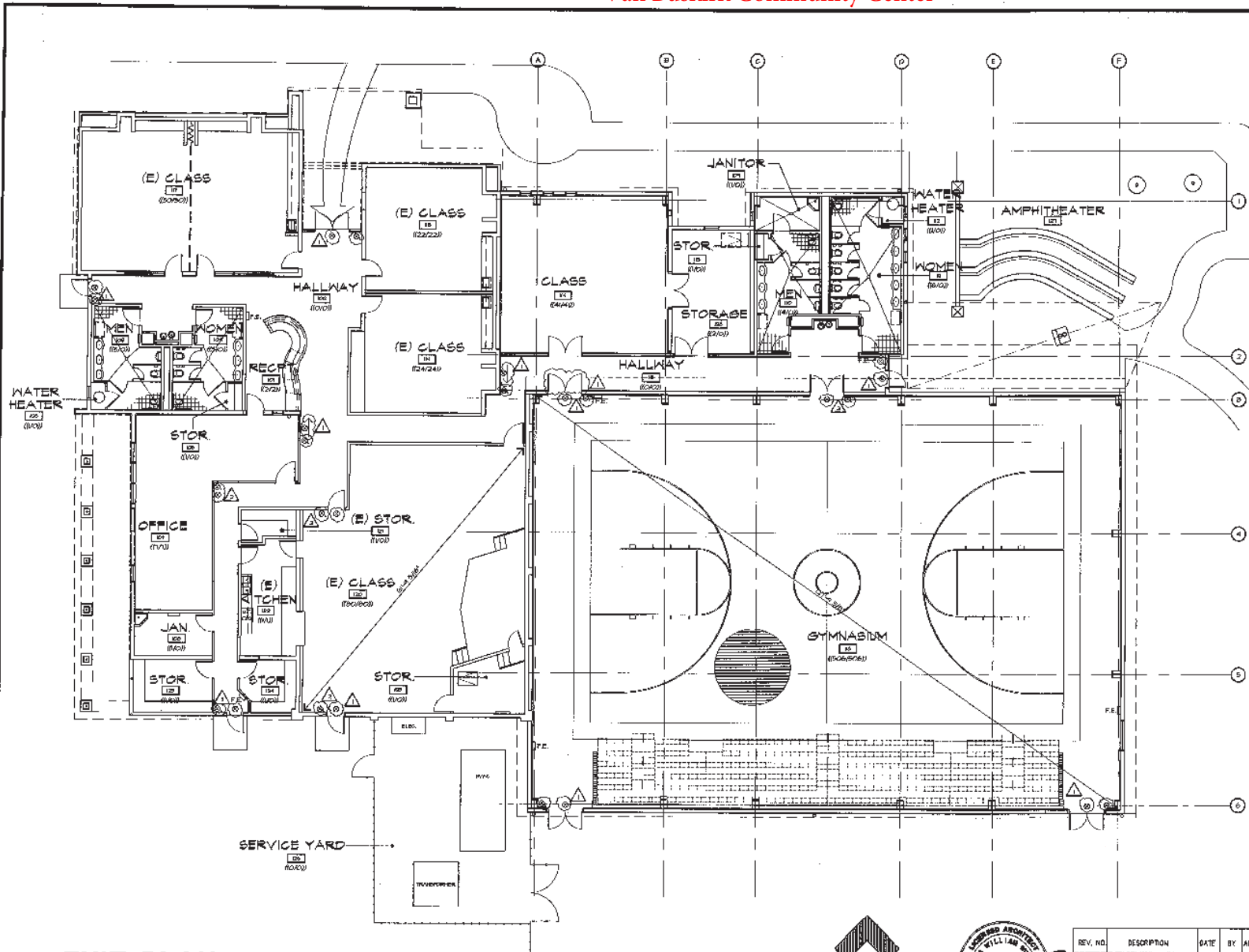

LEGEND

(RXX/00) ROOM OCCUPANT LOAD / CONTRIBUTING OCC. LOAD TO EXIT SCHEME

FE FIRE EXTINGUISHER IN RECESSED WALL CABINET - REFER TO DETAIL SHOWN

⊙ BATTERY BACK-UP ILLUMINATED EXIT SIGN 1'-6" TO CENTER POINT - REFER TO SHEET E21 LIGHTING PLAN

⊙ BATTERY BACK-UP LOW LEVEL ILLUMINATED EXIT SIGN - REFER TO SHEET E21 LIGHTING PLAN

- GENERAL NOTES**
1. FINISH AND INSTALL ROOM CAPACITY SIGNAGE AT ALL ASSEMBLY ROOMS. SIGN SHALL BE OF DURABLE CONSTRUCTION AND CONTRASTING IN COLOR FROM THE BACKGROUND ONTO WHICH IT IS ATTACHED. SIGN SHALL READ "MAXIMUM ROOM CAPACITY XXX". REFER TO NOTED ROOM OCCUPANT LOAD (TNS) PARAMETER FOR CAPACITY VALUES TO BE NOTED ON FINISHING.
 2. FIRE EXTINGUISHER LOCATIONS SHALL BE APPROVED BY THE FIRE DEPARTMENT PRIOR TO INSTALLATION.
 3. TOTAL OCCUPANT LOAD: 750
OCCUPANT LOAD CONTRIBUTING TO EXIT SCHEME: 750

EXIT PLAN



REV. NO.	DESCRIPTION	DATE	BY	APPROVED
1	BACK CHECK			
2	BACK CHECK			

Lesovsky Donaldson Architects, LLP
 4 Emile Green Court, Redwood, CA 94064 | TEL 530 845-0428 | FAX 530 845-0415

VAN BUSKIRK COMMUNITY CENTER
GYMNASIUM ADDITION & RENOVATION
 EXIT PLAN

DEPARTMENT OF PARKS AND RECREATION
 CITY OF STOCKTON

SCALE: 1/4" = 1'-0"

DESIGNED BY: EW
 DRAWN BY:
 CHECKED BY: EW
 RECORD DWG: 05 APR 2005

APPROVED BY: DATE: 1-26-05

SHEET NO. **A0.1**
 2 OF 00 SHEETS
 PUR 06-008

4790-1C